



# DOOR CANOPIES FITTING INSTRUCTIONS BUXTON DECORATIVE

# PRO-CAN DOOR CANOPIES

Your ProCan door canopy kit contains:

ITEM	QTY
Base	1
Lid	1
Fir trees (fixings)	8
Canopy Fixing pack	1

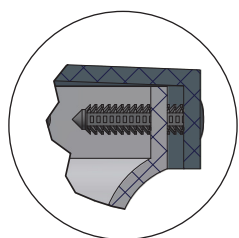
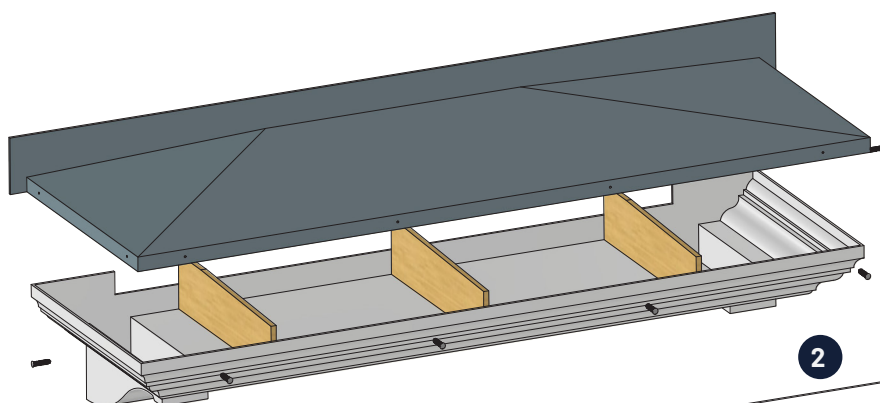

\*Tap fixings totally into canopy.

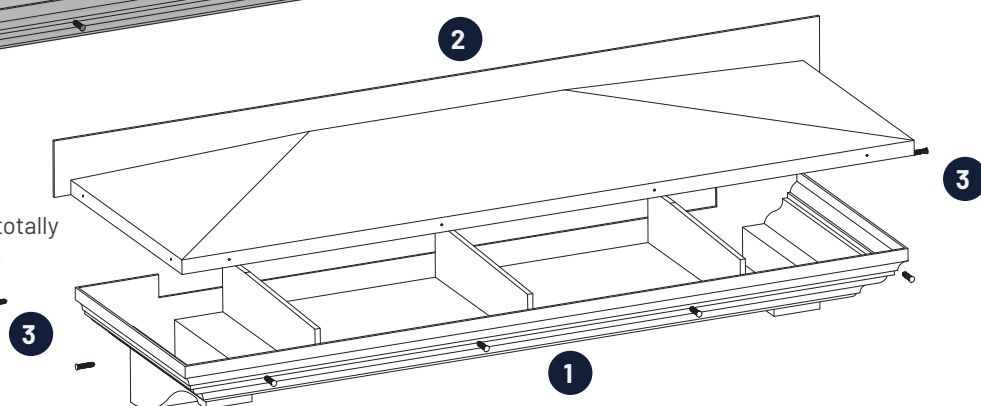

## INSTALLATION

1. Canopy is supplied in two pieces the base unit and the roof that sits on the base unit. Mark the base internally to take fixings at a maximum 450mm centres, it is recommended that two fixings go through the integral kneelers. Drill through the GRP back upstand internally using a 10mm drill.
2. Position canopy against the structure in the correct location, checking the horizontal and vertical alignment. Mark the structure using the pre-drilled holes in the base, drill the structure using a 10mm diameter drill bit to suit the depth of the StormFIX120's.
3. Insert the blue fixing plug sleeves through the GRP base and into the structure, screwing the base back to the structure ensuring the correct alignment is maintained.
4. Mark out the lid fixing positioned on the GRP upstand at a maximum 450mm centres, this roof requires 4 fixings in total pre-drill the fixing holes with a 10mm drill.
5. Centre the canopy lid to the base ensuring equal overhang to the three sides and there is a fall from rear to front. Use the pre-drilled holes as guides to drill the structure using a 10mm diameter drill bit to suit the Stormfix80's plugs. Inset the fixing plug sleeves through the GRP upstand into the structure and screw fix the lid. Conceal the fixings using the grey caps supplied with the Stormfix.
6. Drill through the Lid down stand equally spaced at 300mm max. centres using a 6.5 diameter drill bit. Care is required to ensure the drill holes go through the lid and into the base box detail the lid sits over. Insert the fir tree fasteners into the holes including to the side of the lid to hold the lid to the base.\*
7. Canopy upstand to be sealed by either lead flashing or mastic sealant.



FLAT



ARCHED



MONO PITCH



APEX



## **DOOR CANOPIES FITTING INSTRUCTIONS BUXTON DECORATIVE**

# **PRO•CAN**

**DOOR CANOPIES**

### **Handling**

Mouldings can usually be carried manually. If mechanical handling equipment is used, always use suitable battens or bearers to protect the product. Remove the protective packaging only when fixing is imminent. Care should be taken not to damage the surface of the GRP.

### **Storage**

Always store the canopy on its back i.e. with the fixing flange face downwards, covered and dry. If stored externally, do not expose to direct sunlight whilst inside the packaging.

### **Maintenance**

GRP is low maintenance and will not require regular painting or decorating. To maintain its finish we advise cleaning periodically using an ammonia free detergent solution. Abrasive cleaners, wire wool or scourers should not be used as they may scratch the finished surface.



**FLAT**



**ARCHED**



**MONO PITCH**



**APEX**